

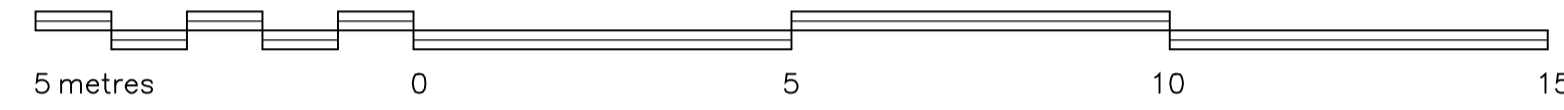

Proposed West Elevation
Scale 1:100



Proposed South Elevation
Scale 1:100



Proposed East Elevation
Scale 1:100

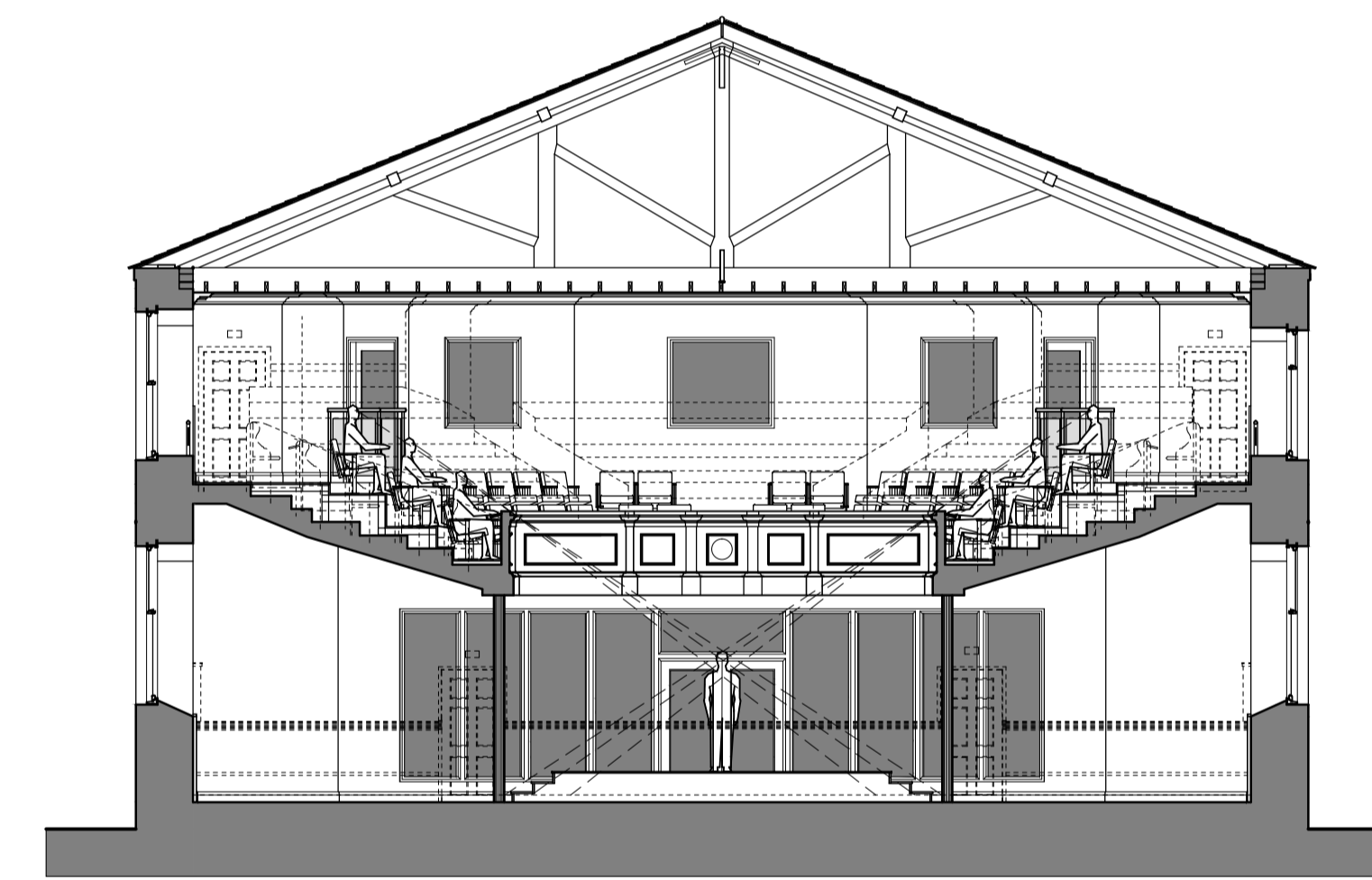

Proposed Cross Section
Scale 1:100



Proposed Longitudinal Section
Scale 1:100

This drawing is copyright. All sizes to be site verified. No dimension to be scaled.

Job title
**Proposed Alterations to
Limekilns Parish Church, Church Street,
Limekilns, Dunfermline, Fife, for
Presbytery of Dunfermline**

Drawing title File Name 675 Planning

Proposed Elevations

Scale 1:50 Drawn ASM Date May 2011

MURDOCH Chartered Architects
METHVEN CASTLE, PERTH PH1 3SU
Tele / Fax: (01738) 840016 E-mail: enquiries@methvencastle.com

675
PL/03

